

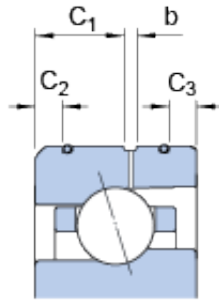

## NTN Bearing Driveshaft do Brasil

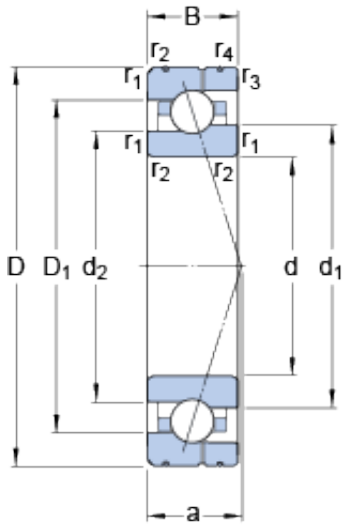

25 mm x 47 mm x 12 mm 25 mm x 47 mm x 12 mm SKF 7005 CE/HCP4AL angular contact ball bearings

Bearing No. 7005 CE/HCP4AL

7005 CE/HCP4AL Bearing 2D drawings and 3D CAD models

Size	47x25x12 mm
Bore Diameter	47 mm
Outer Diameter	25 mm
Width	12 mm
d	25 mm
D	47 mm
B	12 mm
d <sub>1</sub>	31.6 mm
d <sub>2</sub>	29.8 mm
D <sub>1</sub>	39.21 mm
b	2.1 mm
C <sub>1</sub>	5.9 mm
C <sub>2</sub>	1.8 mm
C <sub>3</sub>	1.9 mm
r <sub>1,2</sub> - min.	0.6 mm
r <sub>3,4</sub> - min.	0.3 mm
a	10.8 mm
d <sub>a</sub> - min.	28.2 mm
d <sub>b</sub> - min.	28.2 mm
D <sub>a</sub> - max.	43.8 mm
D <sub>b</sub> - max.	44.6 mm
r <sub>a</sub> - max.	0.6 mm
r <sub>b</sub> - max.	0.3 mm
d <sub>n</sub>	33.1 mm



## NTN Bearing Driveshaft do Brasil

Basic dynamic load rating - C	8.3 kN
Basic static load rating - C <sub>0</sub>	4.2 kN
Fatigue load limit - P <sub>u</sub>	0.173 kN
Limiting speed for grease lubrication	56000 r/min
Limiting speed for oil lubrication	85000 mm/min
Ball - D <sub>w</sub>	6.35 mm
Ball - z	14
G <sub>ref</sub>	1.3 cm <sup>3</sup>
Calculation factor - f <sub>0</sub>	7.5
Preload class A - G <sub>A</sub>	45 N
Preload class B - G <sub>B</sub>	130 N
Preload class C - G <sub>C</sub>	260 N
Calculation factor - f	1.05
Calculation factor - f	1
Calculation factor - f <sub>2A</sub>	1
Calculation factor - f <sub>2B</sub>	1.03
Calculation factor - f <sub>2C</sub>	1.05
Calculation factor - f <sub>HC</sub>	1.01
Preload class A	27 N/micron
Preload class B	41 N/micron
Preload class C	56 N/micron
d <sub>1</sub>	31.6 mm
d <sub>2</sub>	29.8 mm
D <sub>1</sub>	39.21 mm
C <sub>1</sub>	5.9 mm
C <sub>2</sub>	1.8 mm
C <sub>3</sub>	1.9 mm
r <sub>1,2</sub> min.	0.6 mm



## NTN Bearing Driveshaft do Brasil

$r_{3,4}$ min.	0.3 mm
$d_a$ min.	28.2 mm
$d_b$ min.	28.2 mm
$D_a$ max.	43.8 mm
$D_b$ max.	44.6 mm
$r_a$ max.	0.6 mm
$r_b$ max.	0.3 mm
$d_n$	33.1 mm
Basic dynamic load rating C	8.32 kN
Basic static load rating $C_0$	4.15 kN
Fatigue load limit $P_u$	0.173 kN
Attainable speed for grease lubrication	56000 r/min
Attainable speed for oil-air lubrication	85000 r/min
Ball diameter $D_w$	6.35 mm
Number of balls z	14
Reference grease quantity $G_{ref}$	1.3 cm <sup>3</sup>
Preload class A $G_A$	45 N
Static axial stiffness, preload class A	27 N/ $\mu$ m
Preload class B $G_B$	130 N
Static axial stiffness, preload class B	41 N/ $\mu$ m
Preload class C $G_C$	260 N
Static axial stiffness, preload class C	56 N/ $\mu$ m
Calculation factor f	1.05
Calculation factor $f_1$	1
Calculation factor $f_{2A}$	1
Calculation factor $f_{2B}$	1.03
Calculation factor $f_{2C}$	1.05
Calculation factor $f_{HC}$	1.01



## NTN Bearing Driveshaft do Brasil

Calculation factor $f_0$	7.5
Mass bearing	0.065 kg