

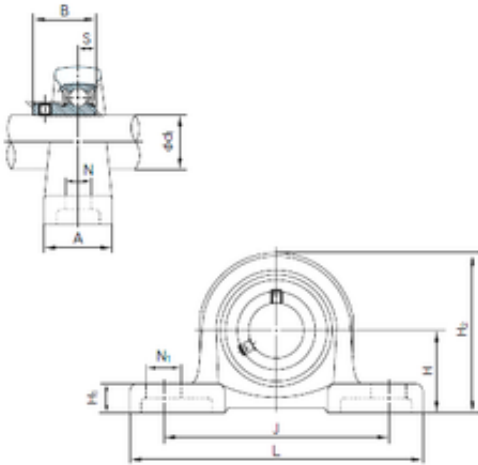

NTN Bearing Driveshaft do Brasil

NACHI BLLP6J bearing units

Bearing No. BLLP6J



BLLP6J Bearing 2D drawings and 3D CAD models

Bore Diameter	30 mm
Width	30.3 mm
d	30 mm
A	33 mm
B	30.3 mm
H	42.9 mm
H1	15 mm
H2	83 mm
J	120 mm
L	156 mm
N	14 mm
N1	21 mm
S	8 mm
Bolt (G)	M12