

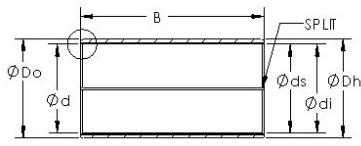

NTN Bearing Driveshaft do Brasil

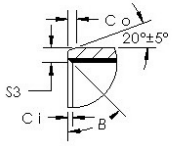

AST AST850BM 9050 plain bearings

Bearing No. AST850BM 9050

Bore Diameter	90 mm
Outer Diameter	95 mm
Bearing Type	metal with bronze
Shaft Dia., Nominal (d)	90.0000
Shaft Size (ds) - 90 +0 / -0.054	90 +0 / 0.054
Housing Bore Dia. (Dh) - 95 +0.035 / -0	95 +0.035 / 0
Bearing Outside Diameter, Nominal(Do)	95.000
Bearing Bore after Mounting (di)	90 +0.235 / +0.080
Average Clearance (Cd)	0.1580
Wall Thickness (S3)	2.430
Bearing Length, Nominal (B)	50.000
Bearing Length Tolerance (B tol.) - +0 / -0.40	+0 / 0.40
OD Chamfer Length (Co)	1.800
ID Chamfer Angle (B deg.)	45
ID Chamfer Length (Ci)	0.600

AST850BM 9050 Bearing 2D drawings and 3D CAD models