

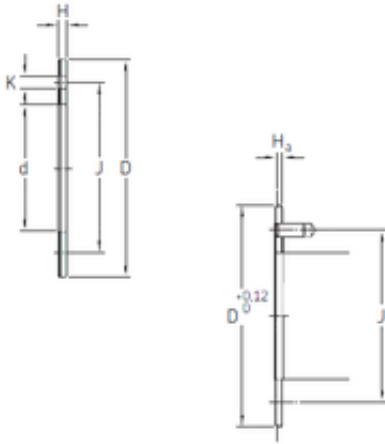

# NTN Bearing Driveshaft do Brasil



## SKF PCMW 122401.5 E plain bearings

Bearing No. PCMW 122401.5 E

PCMW 122401.5 E Bearing 2D drawings and 3D CAD models

Size	12x24x1.5 mm
Bore Diameter	12 mm
Outer Diameter	24 mm
Width	1,5 mm
d	12 mm
D	24 mm
H	1,5 mm
J	18 mm
K	1,75 mm
Ha min.	1 mm
Weight	0,0038 Kg
Basic dynamic load rating (C)	28 kN
D <sub>a</sub>	24 mm
J <sub>a</sub>	18 mm
H <sub>a</sub>	1 mm
Basic dynamic load rating - radial direction C	28 kN
Basic static load rating - radial direction C <sub>0</sub>	85 kN
Specific dynamic load factor K	80 N/mm <sup>2</sup>
Specific static load factor K <sub>0</sub>	250 N/mm <sup>2</sup>
Factor depending on material and bearing type K <sub>M</sub>	300
Permissible sliding velocity v max.	2 m/s



## NTN Bearing Driveshaft do Brasil

Permissible sliding velocity v min.	0 m/s
Coefficient of friction $\mu$ max.	0.25
Coefficient of friction $\mu$ min.	0.03
Mass thrust washer	0.0038 kg