

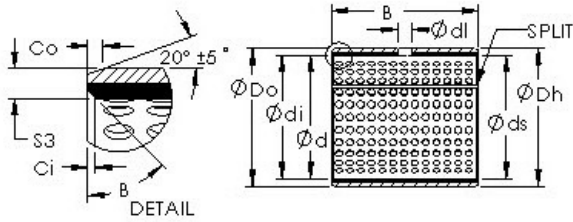

NTN Bearing Driveshaft do Brasil



AST AST20 09IB12 plain bearings

Bearing No. AST20 09IB12

Bore Diameter	14,2875 mm
Outer Diameter	16,6624 mm
Bearing Type	straight
Shaft Dia., Nominal (d)	0.5625
Shaft Size (ds)	0.5522 / 0.5512
Housing Bore Dia. (Dh)	0.6569 / 0.6562
Bearing Outside Diameter, Nominal(Do)	0.656
Bearing Bore after Mounting (di)	0.5569 / 0.5542
Average Clearance (Cd)	0.0040
Wall Thickness (S3)	0.051
Bearing Length, Nominal (B)	0.750
Bearing Length Tolerance (B tol.) - +.010 / -0.010	+0.010 / 0.010
OD Chamfer Length (Co)	0.024
ID Chamfer Angle (B deg.)	30
ID Chamfer Length (Ci)	0.012
Lube Hole Dia. (dl)	0.156
Material	Carbon steel shell with POM plastic liner

AST20 09IB12 Bearing 2D drawings and 3D CAD models